

# Camden

HOMES

## WHITTIER

2650 FAIRMONT ESTATES DR.,  
GREENACRES, WA 99016



### EXTERIOR PAINT

**BODY COLOR:** "INTELLECTUAL GRAY"



**ACCENT COLOR:** 200% TINT  
"INTELLECTUAL GRAY"



**TRIM COLOR:** "WHITE DOVE"

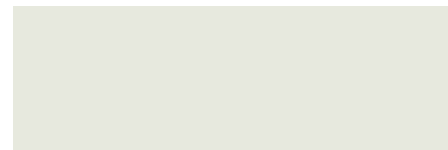

### EXTERIOR MASONRY:

"WHITE BARK"



**ROOF:** "WEATHERED WOOD"



### GARAGE DOORS:

CLOPAY BRIDGEPORT EXTENDED RECESSED  
PANELS W/REC14 WINDOWS  
COLOR "WHITE DOVE"



### SIDING:

PAINT GRADE SHINLES  
STANDARD LAP SIDING

### WINDOWS:

CRAFTSMAN GRID ON  
FRONT  
NO GRIDS ON SIDES & BACK

### GARAGE FRONT LIGHTS:



**FRONT DOOR  
HANDLESET:**  
SCHLAGE  
"BARCELONA" IN  
"OIL RUBBED  
BRONZE"

**FRONT DOOR:**  
3-LITE FIBERGLASS  
DOOR  
EXTERIOR COLOR:  
STAIN-GRADE  
"NATURAL WALNUT"  
INTERIOR COLOR:  
"COLONIAL WHITE"  
TO MATCH INTERIOR  
DOORS & TRIM



**ALL INTERIOR  
DOORS:**  
3-PANEL CRAFTSMAN  
"YARROW"  
PAINT-GRADE  
"PARCHMENT"



**INTERIOR DOOR  
LEVERS:**  
"SOLSTICE"  
IN "OIL RUBBED  
BRONZE"



# Camden HOMES

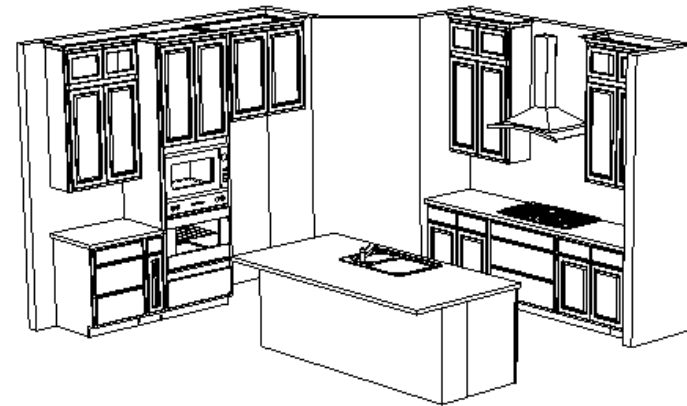

**VANITY LIGHTS:**



**KITCHEN PENDANTS**



**DINING ROOM LIGHT:**



**INTERIOR PAINT COLOR:**

50% TINT OF "AGREEABLE GREY"



**INTERIOR DOOR/TRIM COLOR:**

HUNTWOOD "PARCHMENT"

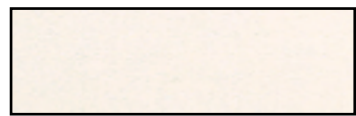

**PAINT GRADE BASE TRIM:**

OGEE "PARCHMENT"



**FLOORING:**

CARPET: MOHAWK, TONAL

ALLURE II "SMOKY SKY"

LVP: PARADIGM, CONQUEST



**MASTER AND MAIN BATH FAUCETS:**

DELTA "WOODHURST" IN "OIL RUBBED BRONZE"



**MAIN BATH SINK:**

OVAL TOP MOUNT SINK



**MASTER BATH SINKS:**

UNDERMOUNT OVAL SINKS IN "WHITE"



**MASTER & MAIN SHOWER FAUCETS :**

DELTA "WOODHURST" IN "OIL RUBBED BRONZE"

**BASEMENT BATH FAUCET:**

OVAL TOP MOUNT SINK  
DELTA "WOODHURST"  
CENTERSSET FAUCET IN "STAINLESS"



**BATHROOM FAUCET :**

DELTA "WOODHURST" IN "STAINLESS"



**BATHROOM SINKS:**

UNDERMOUNT OVAL SINKS IN "WHITE"



**KITCHEN PERIMETER CABINETS ONLY:**

PAINT GRADE "PARCHMENT" WALL STACKED UPpers WITH CLEAR GLASS

**MASTER DECO TILE :**

FLORIDA TILE, PRECIOUS HDP "CALACATTA" (MATTE) HERRINGBONE MOSAIC



**MASTER SHOWER WALL TILE :**

12X24 FLORIDA TILE, PRECIOUS HDP "CALACATTA" (MATTE) 50/50 SUBWAY SET

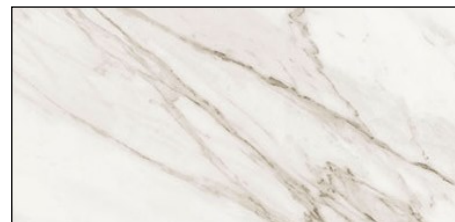

**KITCHEN SINK:**

"STAINLESS STEEL"

60/40 LARGE BOWL LEFT



**KITCHEN CABINET HARDWARE :**

5" PULLS IN "OIL RUBBED BRONZE"



**KITCHEN ISLAND & ALL OTHER CABINETS THROUGHOUT HOME:**

STAIN GRADE "OASIS"



**KITCHEN GRANITE AND BACKSPLASH:**

QUARTZ: 3CM "ENIGMA"

BACKSPLASH: 2.5"X10" BEDROSIANS, MAKOTO TILE, IN "SHOJI WHITE"

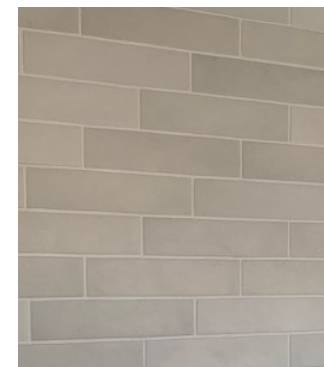
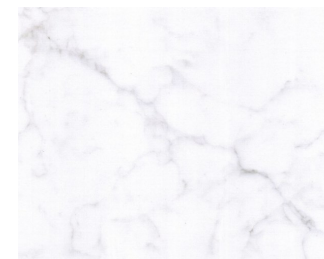

**APPLIANCES: FRIGIDAIRE PROFESSIONAL**

IN "STAINLESS STEEL"

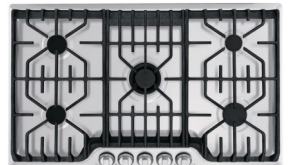

**KITCHEN FAUCET:**

DELTA "ESSA"

IN "OIL RUBBED BRONZE"



**FIREPLACE DETAIL:**

MASONRY FROM FLOOR TO CEILING WITH BASE CABINETS TO LEFT AND RIGHT SIDE. & FLOATING SHELVES INCLUDED WITH FLOATING BOX MANTEL

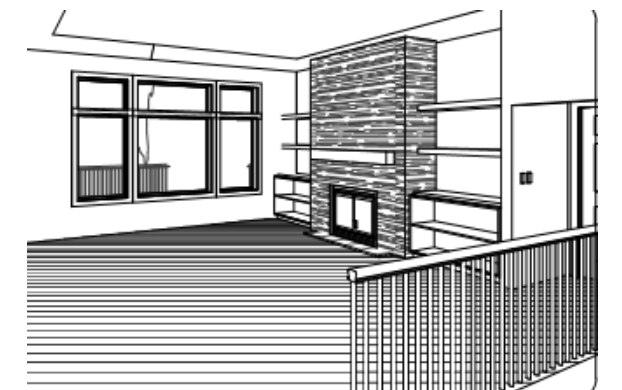

**FIREPLACE STONE:**

"WHITE BARK"

MANTEL:

"OASIS"

