



Parkside RV

Unfinished Basement
2632 S Summit Estates Dr.

\$819,850

Main: 1,323 SF

Upper: 1,738 SF

UNF. BSMT: 1,323 SF

Total: 4,384 SF



3 Car Garage



2.5 Bath



4 Bedrooms

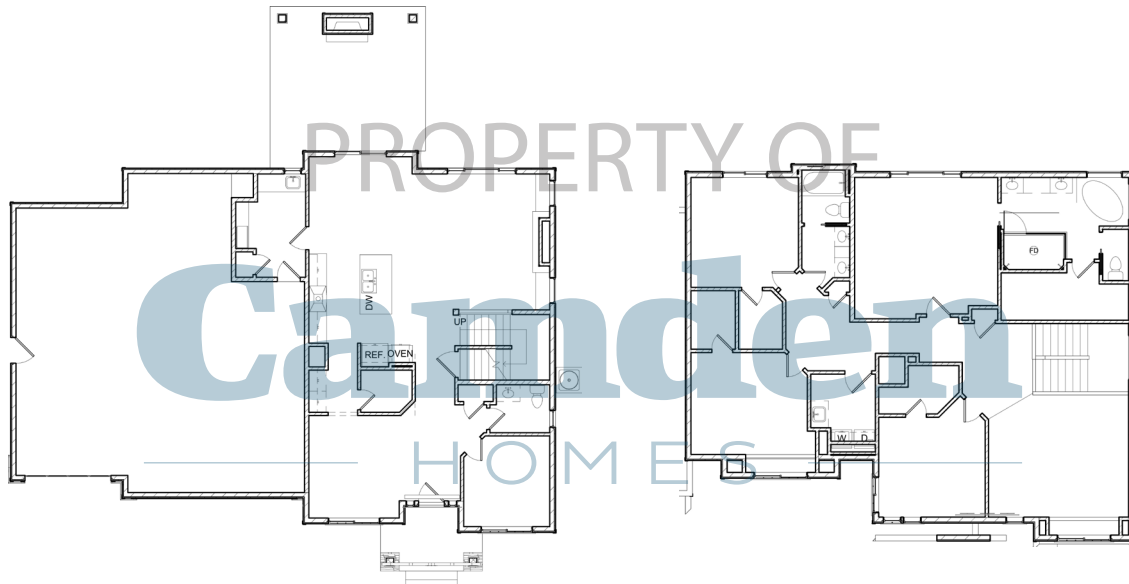

* All items shown are subject to change at Camden Homes Description. All dimensions are approximate and are to be verified prior to any sale. Images may depict upgrades and are not included in base price of home. Prices, incentives, floor plans, square footages, elevations & specifications may change without notice. These illustrations are provided to help our customers and clients visualize living in their new home and are not warranted to be exact.

Brad Boswell
(509) 710-2024
brad@boswellhomes.com



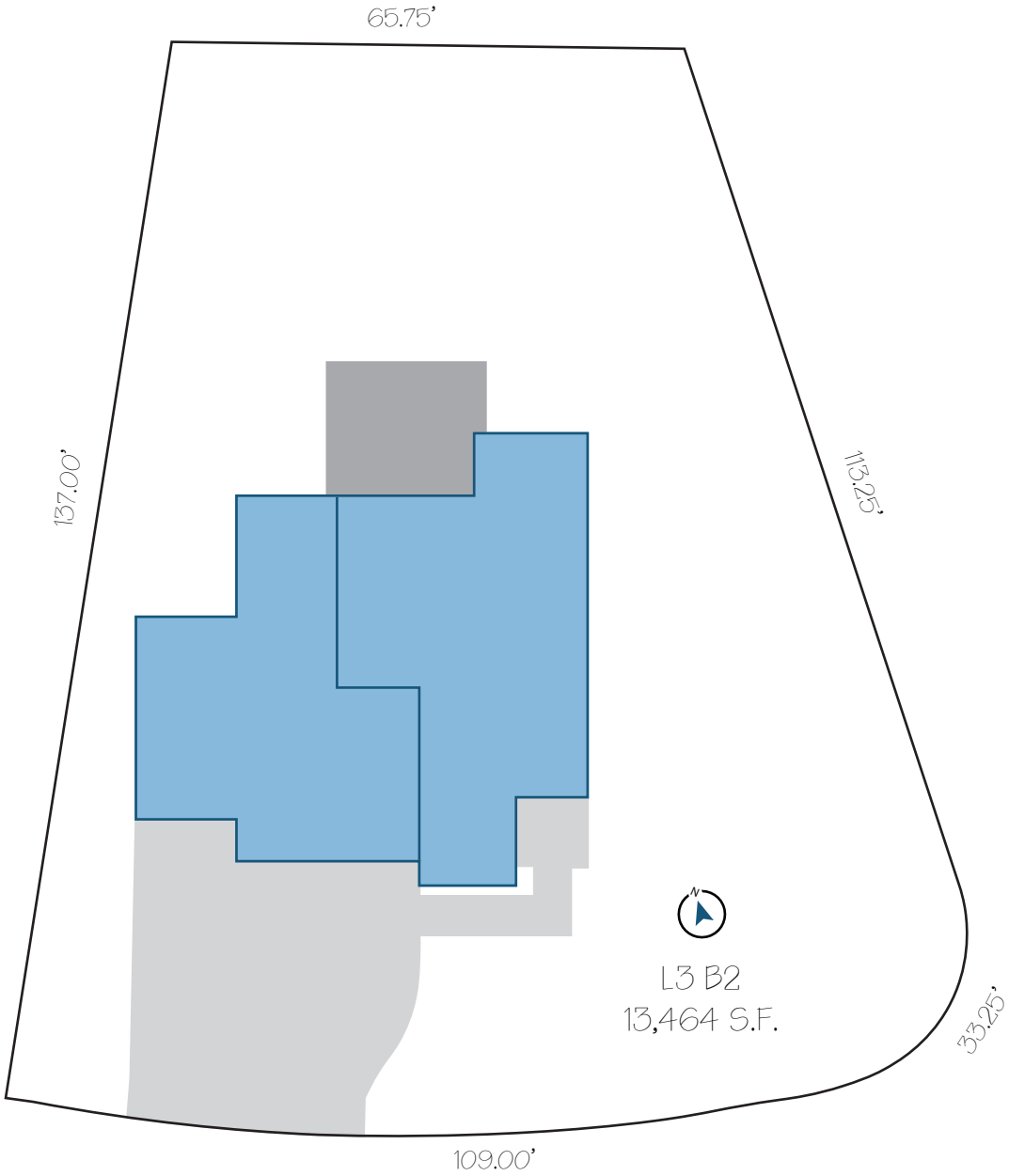

FAIRMONT ESTATES DRIVE



* All items shown are subject to change at Camden Homes Description. All dimensions are approximate and are to be verified prior to any sale. Images may depict upgrades and are not included in base price of home. Prices, incentives, floor plans, square footages, elevations & specifications may change without notice. These illustrations are provided to help our customers and clients visualize living in their new home and are not warranted to be exact.

Brad Boswell
(509) 710-2024
brad@boswellhomes.com

